

2012

Inventory Reduction!

James Plantation

The real estate market is changing and showing signs of getting better! We have more people calling and looking and some builders looking for lots, so they have new houses ready for Spring. We have SLASHED prices to sell out phase I.

more details...

HECHT
Development 
hechtdevelopment.com



704-809-2500 or 704-489-1183
info@hechtdevelopment.com
A HECHT Development Neighborhood



James Plantation

Community Info

Water & Sewer

Water and sewer PAID by Developer. \$7,160 in immediate savings to buyer.

Pricing

Originally priced from \$62,000 to \$115,000, the new prices are \$19,500 to \$44,500. Only 10 lots remaining in Phase 1.

- Bring Your Own Builder
- 0.75 acre to 4 acres
- Lots from \$19,500
- Heavily Wooded
- County Water & Sewer
- Minimum Square Feet - 2300
- Financing: Up to 80% financing for qualified borrowers will be offered thru Peoples Bank. Please contact Mark or Rhonda with Peoples Bank at 704-489-8940. Rfleming@peoplesbanknc.com
- For lot plats, Covenants, or any other questions, please visit www.hechtdevelopment.com and click on "Our Communities" or call Bob Hecht at 704-634-4444.

General Info

- Schools
Rock Springs Elementary
North Lincoln Middle
North Lincoln High
- East Lincoln County Location
- Gated Entry
- One mile from the new four-lane Hwy. 16 Bypass
- Curb & Gutter

Directions

From Charlotte: North on Hwy. 16 to St. James Church Road exit, turn right and continue 3/4 mile to James Plantation on your left.

From Newton: Hwy. 16 South through Denver, turn right on St. James Church Road and continue 3/4 mile. James Plantation will be on your right.

Please Call 704-809-2500 for questions.

HECHT
Development

www.hechtdevelopment.com
A HECHT Development Neighborhood



James Plantation

Preliminary Plat

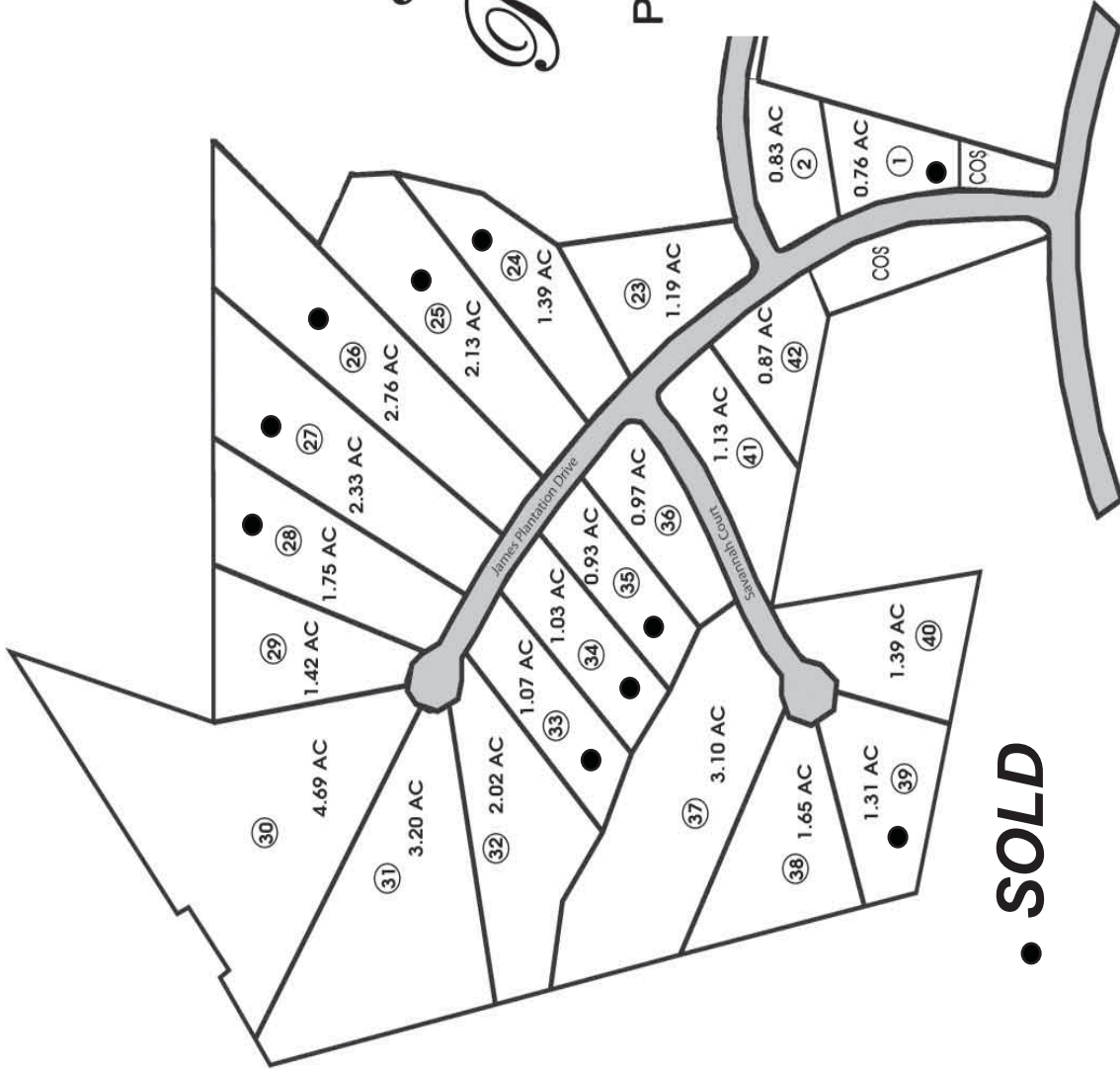

• SOLD

James Plantation

Price List

	Dimensions									
Lot #	Road							Acreage	Price	MLS
23	280	X	260	X	339	X	73	1.19	\$19,500	849600
24	111	X	556	X	335	X	260	1.39	SOLD	SOLD
25	123	X	572	X	218	X	556	2.13	SOLD	SOLD
26	123	X	685	X	250	X	842	2.76	SOLD	SOLD
27	123	X	544	X	250	X	685	2.33	SOLD	SOLD
28	122	X	431	X	214	X	544	1.75	SOLD	SOLD
29	77	X	370	X	265	X	431	1.42	\$29,500	849577
30	46	X	638	X	254x538	X	401x370	4.69	\$44,500	849579
31	56	X	507	X	435	X	50x638	3.20	\$44,500	849575
32	81	X	396	X	139x150	X	108x507	2.02	\$32,900	849578
33	121	X	367	X	143	X	396	1.07	SOLD	SOLD
34	123	X	362	X	128	X	367	1.03	SOLD	SOLD
35	123	X	339	X	116	X	362	0.93	SOLD	SOLD
36	152	X	345	X	81	X	339	0.97	\$19,500	849576
37	205	X	460	X	251	X	757	3.10	\$39,500	849572
38	71	X	324	X	355	X	460	1.65	\$38,500	849640
39	60	X	222	X	290x100	X	324	1.31	SOLD	SOLD
40	96	X	396	X	260	X	222	1.39	\$19,500	849643
41	146	X	267	X	236	X	262	1.13	\$19,500	849646
42	229	X	88	X	263	X	267	0.87	\$19,500	849574

NOTE: Dimensions & Acreage are approximate -- please see lot enlargements for actual figures.
Prices subject to change. 5-4-12.

NEW PRICING

New Homes



Scan with your
Smartphone



3326 CAYTON DRIVE, WYNSWEPT

Just completed and ready for you! Two story living room, formal dining, four bedrooms and large bonus room, granite in kitchen. Main level owner suite. \$264,900. Carolina MLS 981498 or Catawba MLS 9556145



3348 CAYTON DRIVE, WYNSWEPT

Craftsman style ranch with large bonus room. Front and rear porch and just 2 miles from the four-lane Hwy. 16 bypass into Charlotte. \$249,900. Carolina MLS 970213 or Catawba MLS 9555951



3331 CAYTON DRIVE, WYNSWEPT

Brick transitional with lots of upgrades. Energy Star Qualified. 3 bedroom plus bonus, built-in cabinetry, surround sound, and just 2 miles from the four-lane Hwy. 16 bypass into Charlotte. \$295,000. Carolina MLS 935669 or Catawba MLS 9552678



4142 MINERAL LANE, MINERS CREEK

Four bedrooms plus large bonus room in this 1 1/2 story home on wooded lot. North Lincoln schools. Selling below closing costs. \$286,000. Carolina MLS 9560299

SOLD

Hecht Communities



Autumn Woods 3

- Iron Station in East Lincoln County
- Lot Size - 1 acre to 4.5 acres
- 50 lots on 118 acres
- Boat / Camper Storage
- Priced from \$29,900 to \$64,800



Fairfield Forest 4

- Denver in East Lincoln County
- Convenient to Golf, Swim & Tennis
- 50 Lot Community, Less than Half Remaining
- Sidewalks & Streetlights, Cty Water & Sewer
- Priced From \$24,500 to \$29,500



James Plantation 5

- Denver in East Lincoln County
- 3/4 Mile from Highway 16 Bypass
- 21 Lots , 1 to 4.5 Acres, Gated Entry
- Streetlights, County Water & Sewer
- Priced from \$19,500 to \$44,500



Kerns Meadow 2

- Huntersville in North Mecklenburg
- Lot Size - about 3/4 of an Acre
- Gated Entry 12 Lot Community
- ONLY 1 LOT REMAINING
- Priced at \$28,500



Killian Crossing 1

- Denver in East Lincoln County
- Lot Size - 1/2 Acre Plus
- Established Community, County Water
- Over 49 acres Common Open Space
- Priced from \$20,950 - \$26,250



WynSwept 6

- Maiden in S.E. Catawba County
- Lot Size - 3/4 acre to Over 2 Acres
- Two Miles from Highway 16 Bypass
- Priced from \$22,500
- New Homes Available

