



*Build your
dream home...*

James Plantation

more details...

HECHT
Development 
hechtdevelopment.com



704-809-2500 or 704-489-1183
info@hechtdevelopment.com
A HECHT Development Neighborhood



James Plantation

Community Info

- East Lincoln County Location
- Gated Entry
- One mile from the new four-lane Hwy. 16 Bypass
- Curb & Gutter
- Bring Your Own Builder
- 0.75 acre to 4 acres
- Lots from the \$30's
- Heavily Wooded
- County Water & Sewer
- Minimum Square Feet - 2300

General Info

Owner Association Dues:

\$337 per quarter to maintain gated entry and common areas

Schools:

Rock Springs Elementary
North Lincoln Middle
North Lincoln High

Directions:

From Charlotte: North on Hwy. 16 to St. James Church Road exit, turn right and continue 3/4 mile to James Plantation on your left.

From Newton: Hwy. 16 South through Denver, turn right on St. James Church Road and continue 3/4 mile. James Plantation will be on your right.

Note: The Lincoln County Public Utility fees have been paid by the James Plantation developer and no additional fees due by purchaser.

This represents a SIGNIFICANT SAVINGS over other communities!

For Architectural Review, water and sewer questions please call Bob Hecht at 704-634-4444.

For lot plats, Covenants Conditions and Restrictions and Architectural Landscape Guidelines please visit hechtdevelopment.com

Please Call 704-489-1183 for questions.

HECHT
Development

www.hechtdevelopment.com
www.hechtdevelopmentblog.com
A HECHT Development Neighborhood



James Plantation

Preliminary Plat

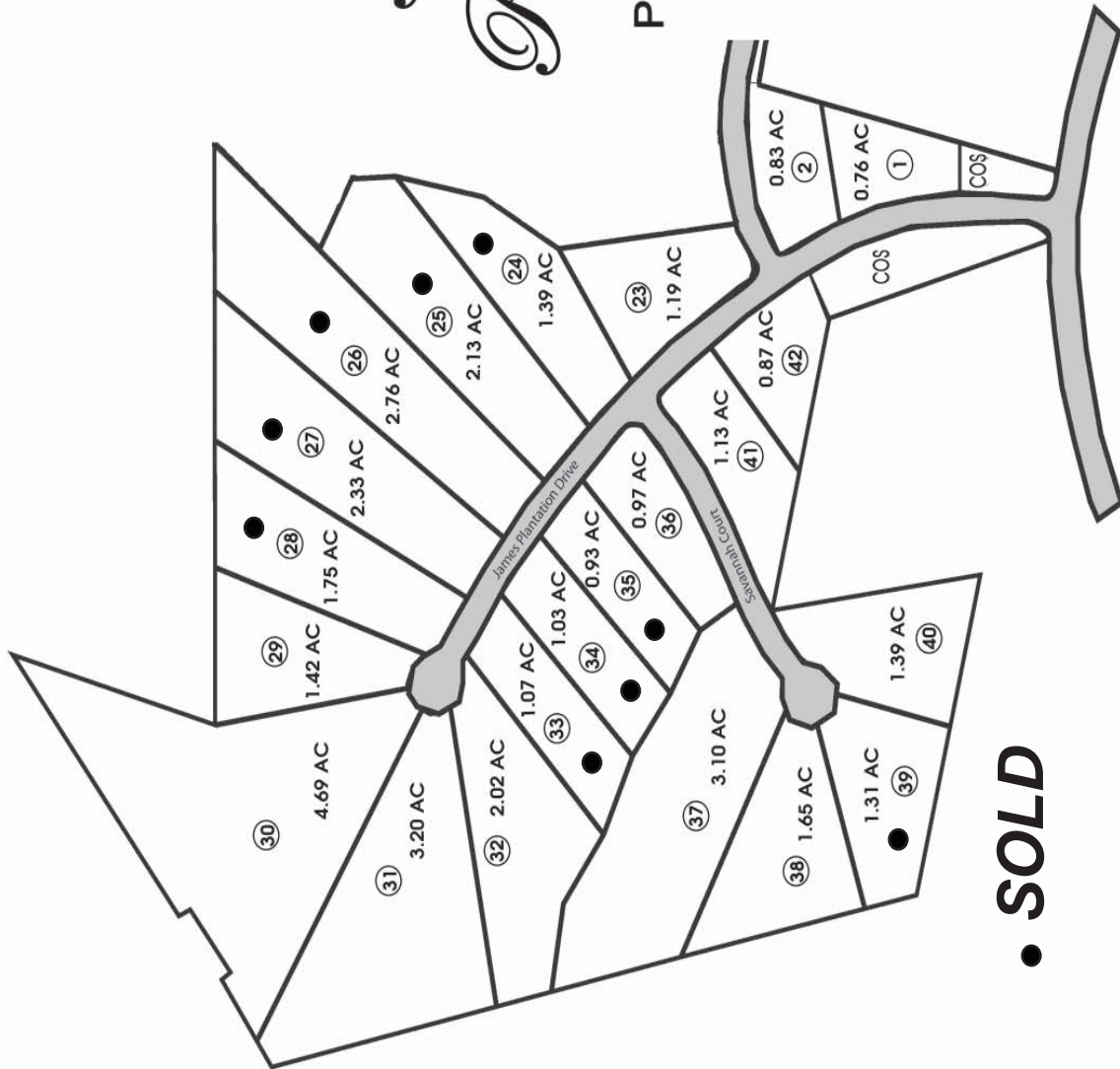

• **SOLD**

James Plantation

Price List

	Dimensions									
Lot #	Road						Acreage	Price	MLS	
1	NOT ON MARKET									
23	280	X	260	X	339	X	73	1.19	\$37,500	849600
24	111	X	556	X	335	X	260	1.39	SOLD	SOLD
25	123	X	572	X	218	X	556	2.13	SOLD	SOLD
26	123	X	685	X	250	X	842	2.76	SOLD	SOLD
27	123	X	544	X	250	X	685	2.33	SOLD	SOLD
28	122	X	431	X	214	X	544	1.75	SOLD	SOLD
29	77	X	370	X	265	X	431	1.42	\$43,900	849577
30	46	X	638	X	254x538	X	401x370	4.69	\$75,000	849579
31	56	X	507	X	435	X	50x638	3.20	\$79,000	849575
32	81	X	396	X	139x150	X	108x507	2.02	\$66,500	849578
33	121	X	367	X	143	X	396	1.07	SOLD	SOLD
34	123	X	362	X	128	X	367	1.03	SOLD	SOLD
35	123	X	339	X	116	X	362	0.93	SOLD	SOLD
36	152	X	345	X	81	X	339	0.97	\$39,900	849576
37	205	X	460	X	251	X	757	3.10	\$69,000	849572
38	71	X	324	X	355	X	460	1.65	\$79,000	849640
39	60	X	222	X	290x100	X	324	1.31	SOLD	SOLD
40	96	X	396	X	260	X	222	1.39	\$49,000	849643
41	146	X	267	X	236	X	262	1.13	\$36,500	849646
42	229	X	88	X	263	X	267	0.87	\$36,500	849574

NOTE: Dimensions & Acreage are approximate -- please see lot enlargements for actual figures.
Prices subject to change.

Please visit our other HECHT Communities!

① Killian Crossing

New Homes from the \$300's - Lots from the \$30's
I-77, Exit 36, Hwy 150 West for 11.5 miles, left on
Grassy Creek, Killian Crossing on left.

② Kerns Meadow

Gated Entry - Prices from \$29,500
I-77, Exit 18, travel West on Vance Road,
left on Mt. Holly-Huntersville Road, first right on
Kerns Road to Kerns Meadow on left.

③ Autumn Woods

One Acre + Lots from \$49,000
From the corner of Hwy 16 & Hwy 73,
take Hwy 73 West for 3.5 miles, right on Ingleside
Farm, left on Ingleside Farm, Autumn Woods on
the right.

④ Fairfield Forest

Lots from the low \$40's
From the corner of Hwy 16 & Hwy 73,
take Hwy 16 North for 3.7 miles, right on
Fairfield Forest Road, Fairfield Forest on the left.

⑤ James Plantation

Gated Entry, Lots from \$36,500 - New Homes Available
From the corner of Hwy 16 & Hwy 73, take
Hwy 16 North 7 miles into Denver, left on St. James
Church Rd, James Plantation on the right.

⑥ WynSwept

New Homes starting in the \$250's - Lots from the \$30's
I-77 Exit 36, Hwy 150 West, right on Hwy 16,
WynSwept on right. Or, from corner of Hwy 16
& Hwy 73, North on Hwy 16 for 13.5 miles,
WynSwept on right.



HECHT
Development

704-809-2500 or 704-489-1183
hechtdevelopment.com
info@hechtdevelopment.com

